



Poly-Iso Panels From PermaTherm

[PermaTherm](#) is proud to announce that we are now taking orders for our newest offering, PermaCore panels. Features of PermaCore:

- Gen 4 poly-iso panels (no off-gassing)
- Maximum R-value per inch
- Meet the highest [EPA standards](#),

With PermaCore, you can choose between two panel-joint options:

- **PermaCore HF** The hidden fastener joint for a variety of uses including exterior walls.
- **PermaCore CS** – The Cold storage joint, which virtually eliminates air entry/loss and thermal bridging.

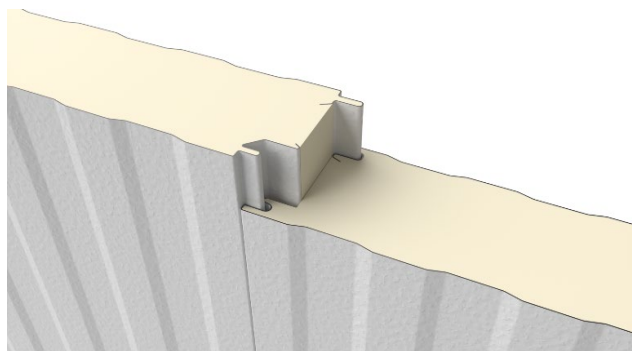

PermaCore-HF | Mesa | Stucco Embossed

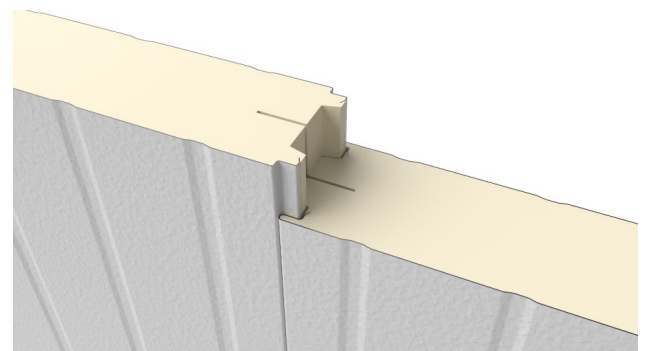

PermaCore-CS | Classic Shadow Line | Stucco



Any cold-storage solutions expert worth their salt would tell you that notching your panels is a must-have in your freezer project.

Thanks to our newest poly-iso machine, we are proud to announce that the money, manpower, and time spent notching panels on-site can be a thing of the past with our factory-notching PermaShield technology. (Available on either joint)

